

ProRF

RFID Access Control Terminal

ZKT_{ECO}



ProRF is an elegantly designed RFID access control terminal. Its IP67 water-proof & dust-proof level enables direct outdoor installation, and is even able to normally operate under extreme weather conditions in a temperature range of -20°C~65°C.

As an advanced terminal, ProRF is equipped with 2 relays of lock, alarm control, SRB for enhanced security, and auxiliary smoke detection input for fire security linkage. Its large storage capacity of up to 100,000 users/cards and 600,000 transactions is perfectly applicable to mega-size enterprise.

Features

- IP-based terminal, support either standalone or network deployment
- IP67 waterproof design suitable for indoor or outdoor applications
- Operating temperature: -20°C~65°C (-4°F~149°F)
- Full access control features

Specifications (GL Exclusive Feature)

Capacity

 Users / Cards: 60,000
100,000 (Optional)
Transactions: 600,000

Communication

TCP / IP
RS232 / RS485*
Wiegand Input / Output
Security Relay Box

Access Control Interface

Lock Relay Output
Alarm Output / Auxiliary Input
Exit Button / Door Sensor
Doorbell Output

Hardware

1.0GHz High Speed CPU
Memory 64MB RAM / 128MB Flash
125KHz EM Reader / 13.56 MHz MF (Optional)
Beep & LED Indicator

Standard Functions

Access Levels / Groups / Holidays
DST / Bell Schedule

Compatibility

Wiegand Slave Reader
ZKBioSecurity

Special Functions

 IP67

Additional Info

Working Temperature: -20 °C ~ 65 °C
(-4 °F ~ 149 °F)
Dimensions: 131* 80 * 20.6 mm

Power

Operating Voltage 12V DC
Current Draw < 500mA

* Note: RS232 is for external printer and RS485 is for RS485 readers.

Configuration

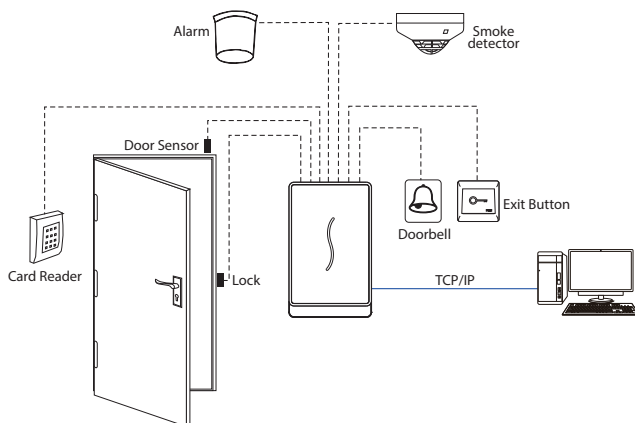

Dimensions (mm)

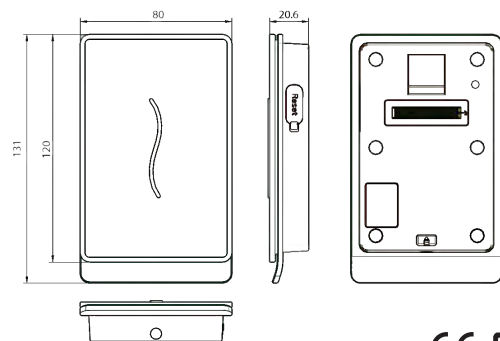

CE FC  RoHS



SISTEMAS BYACCESS, S.L.
C/ Puente de Madrid, 28
28412 - Cerceda - Madrid - SPAIN
Tel: +34 918 420 129
Info@byaccess.com
byaccess.com



Sistemas Seguridad.com
sistemas-seguridad.com

